

**NOTICE OF PROPOSED ORDINANCE
CITY OF SPRINGFIELD, FLORIDA**

ORDINANCE NO.: 413

**** OFFICIAL RECORDS **
BOOK: 2074 PAGE: 157**

AN ORDINANCE ANNEXING REAL PROPERTY IN AN UNINCORPORATED AREA OF BAY COUNTY, WHICH IS CONTIGUOUS TO THE CITY OF SPRINGFIELD IN BAY COUNTY, FLORIDA, UPON PETITION OF ITS OWNERS, AND MAKING THE UNINCORPORATED AREA A PART OF SAID CITY FOR ALL PURPOSES; AND PROVIDING FOR THE ADOPTION, PURSUANT TO CHAPTER 163, LAWS OF FLORIDA, OF AN AMENDMENT OF THE COMPREHENSIVE PLAN OF THE CITY OF SPRINGFIELD, FLORIDA; APPROVING TRANSMITTAL TO THE FLORIDA DEPARTMENT OF COMMUNITY AFFAIRS AS PROVIDED BY CHAPTER 163, FLORIDA LAWS; REPEALING ALL ORDINANCES OR PARTS THEREOF IN CONFLICT; AND PROVIDING THAT THIS ORDINANCE SHALL TAKE EFFECT AS PROVIDED BY LAW.

The adoption hearing and second reading of the above titled Ordinance is scheduled for October 1, 2001, at 6:30 p.m. at the regularly scheduled Springfield City Commission Meeting. The Planning Board will conduct a public hearing on said Ordinance on September 17, 2001, at 6:30 p.m., in the Planning Board Room, in the City Hall. The proposed Ordinance may be inspected during regular business hours in the City Clerk's Office. Interested parties may appear at the meeting and be heard with respect to said proposed Ordinance.

If a person decides to appeal any decision made by the City Commission with respect to any matter considered at the meeting, if an appeal is available, such person will need a record of the proceeding and such person may need to ensure that a verbatim record of the proceeding is made, which record includes the testimony and evidence upon which the appeal is to be based.

Any person requiring a special accommodation at this meeting because of a disability or physical impairment should contact Joyce H. Maynor, City Clerk, at City Hall, 3529 E. 3rd Street, Springfield, Florida, 32401 or by telephone at (850) 872-7570 at least five (5) calendar days prior to the meeting.

THE AREA AND LOCATION OF THE ANNEXATION IS SHOWN BELOW IN THE SHADED AREA:

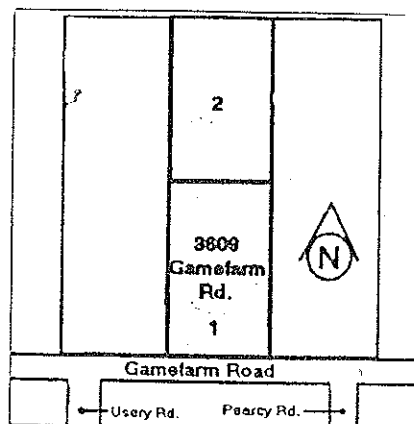

RCD 10M 04 2001 11:50am
HAROLD BAZZEL, CLERK

CITY OF SPRINGFIELD, FLORIDA

ORDINANCE NO.: 413

**** OFFICIAL RECORDS **
BOOK: 2074 PAGE: 154**

AN ORDINANCE ANNEXING REAL PROPERTY IN AN UNINCORPORATED AREA OF BAY COUNTY, WHICH IS CONTIGUOUS TO THE CITY OF SPRINGFIELD IN BAY COUNTY, FLORIDA, UPON PETITION OF ITS OWNERS, AND MAKING THE UNINCORPORATED AREA A PART OF SAID CITY FOR ALL PURPOSES; AND PROVIDING FOR THE ADOPTION, PURSUANT TO CHAPTER 163, LAWS OF FLORIDA, OF AN AMENDMENT OF THE COMPREHENSIVE PLAN OF THE CITY OF SPRINGFIELD, FLORIDA; APPROVING TRANSMITTAL TO THE FLORIDA DEPARTMENT OF COMMUNITY AFFAIRS AS PROVIDED BY CHAPTER 163, FLORIDA LAWS; REPEALING ALL ORDINANCES OR PARTS THEREOF IN CONFLICT; AND PROVIDING THAT THIS ORDINANCE SHALL TAKE EFFECT AS PROVIDED BY LAW.

BE IT ORDAINED BY THE CITY COMMISSION OF THE CITY OF SPRINGFIELD,

WHEREAS, the sole owners of real property described herein which lies in an unincorporated area of Bay County, Florida, have petitioned said City to annex said property, and

WHEREAS, the governing body of said City has determined that the real property described herein lies in an unincorporated area of Bay County, Florida, and

WHEREAS, the proposed ordinance of annexation was read by the title, or in full, at the meeting of the governing body for the City held on the first day of October, 2001, and said proposed Ordinance was published in Panama City News Herald each week for two consecutive weeks beginning with the 10 day of September, 2001, and proof of said publication having been filed among the records of the City in the office of the City Clerk, and

WHEREAS, the proposed ordinance has received a favorable recommendation by the Planning Board of the City of Springfield, and

WHEREAS, all the provisions of Section 171.044 and 163, Florida Statutes, have fully complied with,

NOW, THEREFORE, BE IT ENACTED BY THE PEOPLE OF SPRINGFIELD IN BAY COUNTY, FLORIDA.

Part I: Voluntary Annexation:

Section 1: The following described real property in an unincorporated area of Bay County which is contiguous to the City of Springfield in Bay County, Florida, is hereby annexed to and shall hereafter be considered to be a part of the territorial area of the City of Springfield in Bay County, Florida, and within the City Limits of the City to the same extent as though said lands had originally been incorporated within the boundaries of said City, to-wit:

Owner: Larry Raffield

Description: **Parcel 1**

The South 165 Feet of the West 100 feet of Lot 42, Located in Section 25, Township 3 South, Range 14 West, Bay County Florida, LESS AND EXCEPT the South 30 feet there of.

Parcel 2

The North 165 Feet of the West 100 feet of Lot 42, Located in Section 25, Township 3 South, Range 14 West, Bay County Florida. LESS AND EXCEPT the South 30 feet there of.

Parcel Number: 11930 000 000

Section 2: The boundary lines of the City of Springfield in Bay County, Florida, are redefined so as to include therein said property described above.

Section 3: This parcel shall be designated for Institutional use as described in the City of Springfield Land Development Code and Comprehensive Land Plan of the City of Springfield, Florida.

Part II: Adoption of Small Scale Comprehensive Plan Amendment:

Section 1: This Ordinance is the adoption of a Small Scale Comprehensive Plan Amendment to the City of Springfield Comprehensive Plan Ordinance, and consists of change in the future land use map to include the above described parcel.

Section 2: This Amendment to the Springfield Comprehensive Plan does hereby repeal all portions of the Springfield Comprehensive Plan that are inconsistent or in conflict with this Amendment to the Springfield Comprehensive Plan, and the City of Springfield Comprehensive Plan is hereby amended as set forth in this Ordinance and consists of the following:

A. **Parcel 1**

The South 165 Feet of the West 100 feet of Lot 42, Located in Section 25, Township 3 South, Range 14 West, Bay County Florida, LESS AND EXCEPT the South 30 feet there of.

Parcel 2

The North 165 Feet of the West 100 feet of Lot 42, Located in Section 25, Township 3 South, Range 14 West, Bay County Florida. LESS AND EXCEPT the South 30 feet there of.

An official, true correct copy of all Elements of the City of Springfield Comprehensive Plan as adopted and amended from time to time shall be maintained by the City Commissioners or it's designee.

Section 3: If any provision of this Ordinance or the application thereof to any person or circumstances is held invalid, shall not affect any other provisions or applications of this Ordinance or the City of Springfield Comprehensive Plan which can be given effect without the invalid provision or application, and to this end the provisions of this Ordinance are declared severable.

Section 4: The effective date of this small scale development plan amendment shall be 31 days after adoption, unless the amendment is challenged pursuant to Section 163.3187 (3), F.S. If challenged, the effective date of this amendment shall be the date a final order is issued by the Department of Community Affairs, or the Administration Commission, finding the amendment in compliance with Section 163.3184, F.S. No development orders, development permits, or land uses dependent on this amendment may be issued or commence before it has become effective. If a final order of noncompliance is issued by the Administration Commission, this amendment may nevertheless be made effective by adoption of a resolution affirming its effective status, a copy of which resolution shall be sent to the Department of Community Affairs, Bureau of Local Planning, 2740 Centerview Drive, Tallahassee, Florida 32399-21000.

PASSED AND ADOPTED by the City Commissioners, in Regular Session, in Springfield, Bay County, Florida, this 1st day of October, 2001.

**CITY COMMISSION OF
SPRINGFIELD, FLORIDA**

By 
ROBERT E. WALKER, MAYOR

ATTEST:

JOYCE H. MAYNOR, CITY CLERK

Planning Board Approval and Recommendation: September 17, 2001

First Reading: September 4, 2001

Second Reading: October 1, 2001

Dates Published: 9/10/01, 9/17/01

CITY OF SPRINGFIELD
ANNEXATION REQUEST

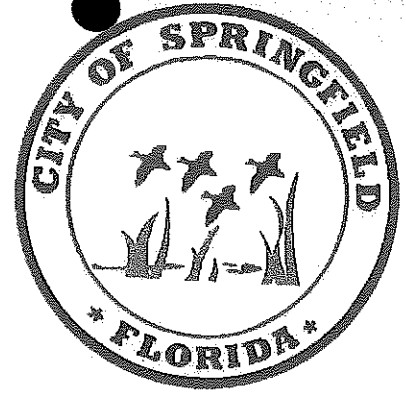

To: City of Springfield
3529 E. 3rd St.
Springfield, Fl. 32401

Date: Aug. 24, 2001

I, the undersigned owner of said property listed below, hereby request that this property be annexed into the City of Springfield.

How do you intend to use the property? (For example: Residential, Rental, Commercial)

RESIDENTIAL

Total number of persons residing at this address: 2 Will it be homesteaded? YES

Physical address: 3609 E. GAME FARM ROAD

Legal Description: (Please attach deed, if applicable) _____

Parcel identification number:

1	1	9	3	9	0	0	0	0	0	0
---	---	---	---	---	---	---	---	---	---	---

[Signature]
Witness Signature
TERRY L. RICHARDSON
Please Print Name

[Signature]
Owner's Signature
Larry C Raffield
Please Print Name

3609 E. Gamefarm Rd.
Address
Panama City, Fla. 32404
1-850-769-9785
Telephone Number