

ORDINANCE NO. 505

AN ORDINANCE ANNEXING THE FOLLOWING UNINCORPORATED AREAS OF BAY COUNTY WHICH ARE CONTIGUOUS TO THE CITY OF SPRINGFIELD, FLORIDA, UPON PETITION OF THE OWNER OF SAID PROPERTY: 5328 EAST 14TH STREET AND TWO ADJACENT PARCELS; 5400 EAST 14TH STREET; 1323 ETHERIDGE AVENUE AND AN ADJACENT PARCEL ON ETHERIDGE AVENUE; REDEFINING THE BOUNDARY LINES OF THE CITY; PROVIDING THAT THIS ORDINANCE SHALL TAKE EFFECT IMMEDIATELY UPON PASSAGE.

WHEREAS, Jerry M Pybus, Trustee, owner of real property in an unincorporated area of Bay County which is contiguous to this City, has filed a petition praying that said real property, being more particularly described below, be annexed to this City, and

WHEREAS, the City Commission of this City has determined that the petition bears the signatures of all the owners of the property in the area proposed to be annexed, and

WHEREAS, Notice of Voluntary Annexation for this property has been published in the Panama City News-Herald once a week for two (2) consecutive weeks prior to this date, the same being a newspaper of general circulation in this City.

NOW, THEREFORE, BE IT ENACTED BY THE PEOPLE OF THE CITY OF SPRINGFIELD, FLORIDA:

Section 1. It is hereby annexed and made a part of the City of Springfield, Florida, the following described lands in Bay County, Florida, to-wit:

SEE ATTACHED AND INCORPORATED EXHIBIT A

Section 2. The boundary lines of the City of Springfield, Florida, are redefined to include therein said tracts of land.

Section 3. A map of the area to be annexed is attached.

Section 4. This ordinance shall take effect immediately upon passage.

PASSED, APPROVED AND ADOPTED at the regular meeting of the City Commission of the City of Springfield, Florida, this 6th day of February, 2012.

Robert E. Walker, Mayor

ATTEST:

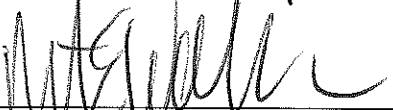

Anne Andrews, City Clerk

EXAMINED AND APPROVED by me this 6th day of February, 2012.

Robert E. Walker, Mayor

PUBLISHED in the Panama City News-Herald on the 23rd day of January and the 30th day of January, 2012.

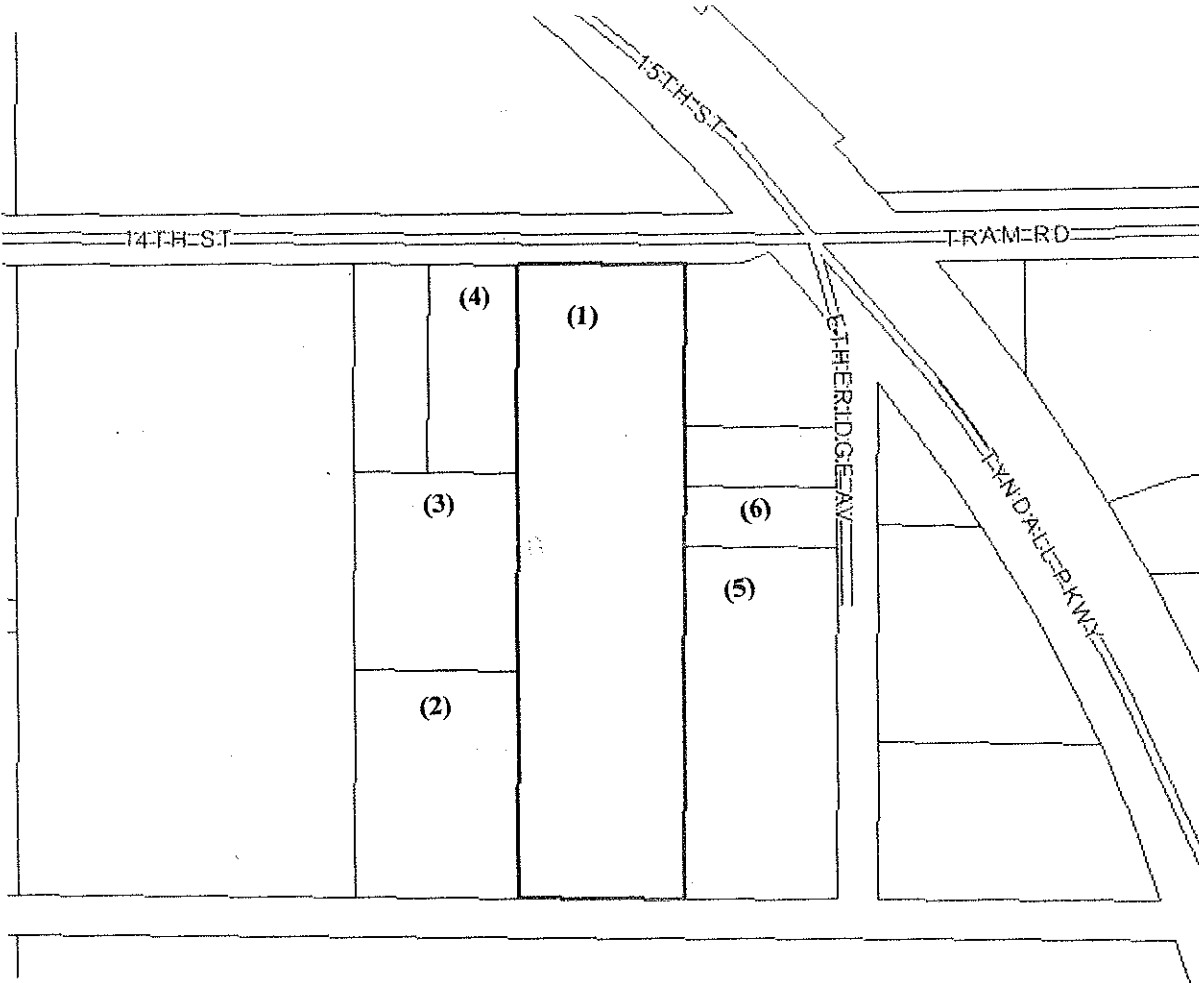
ATTACHMENT TO ORDINANCE NO. 505



**PARCEL 1: 14972-000-000
E. 14TH STREET**

**PARCEL 2: 14971-000-000
5400 E. 14TH STREET**

**PARCEL 3: 14971-010-000
E. 14TH STREET**

**PARCEL 4: 14970-000-000
5328 E. 14TH STREET**

**PARCEL 5: 14915-000-000
ETHERIDGE AVENUE**

**PARCEL 6: 14913-000-000
1323 ETHERIDGE AVENUE**