

**ORDINANCE NO. 540**

**AN ORDINANCE ANNEXING THE FOLLOWING UNINCORPORATED AREA OF BAY COUNTY WHICH IS CONTIGUOUS TO THE CITY OF SPRINGFIELD, FLORIDA UPON PETITION OF THE OWNER OF SAID PROPERTY: PROPERTY CONTAINING APPROXIMATELY 0.266 ACRES AND LOCATED ON HYDE AVENUE, SOUTH OF EAST GAME FARM ROAD, PROPERTY ID 12521-010-000, AS MORE PARTICULARLY DESCRIBED IN THE ORDINANCE; REDEFINING THE BOUNDARY LINES OF THE CITY; PROVIDING FOR REPEAL OF ORDINANCES IN CONFLICT HEREWITH; PROVIDING FOR SEVERABILITY; AND PROVIDING THAT THIS ORDINANCE SHALL TAKE EFFECT IMMEDIATELY UPON PASSAGE.**

**WHEREAS, David Head, owner of real property in an unincorporated area of Bay County which is contiguous to this City, has filed a petition on the 17th day of April, 2017, praying that said real property, being more particularly described below, be annexed to this City, and**

**WHEREAS, Chapter 171, Florida Statutes provides the exclusive method of municipal annexation in order to ensure sound urban development, accommodation to growth, and the provision of municipal services to those areas, and**

**WHEREAS, the City Commission has determined that the area to be annexed is contiguous and reasonably compact, annexation of said property will not result in the creation of any enclaves, and the property otherwise fully complies with the requirements of State law; and**

WHEREAS, the City Commission of this City has determined that the petition bears the signatures of all the owners of the property in the area proposed to be annexed, and

WHEREAS, Notice of Voluntary Annexation for this property has been published in the Panama City News-Herald once a week for two (2) consecutive weeks prior to this date, the same being a newspaper of general circulation in this City.

NOW, THEREFORE, BE IT ENACTED BY THE PEOPLE OF THE CITY OF SPRINGFIELD, FLORIDA:

Section 1. Annexation of Real Property. The real property described herein shall be, and is hereby annexed and made part of the City of Springfield, Florida. This real property is described in "EXHIBIT A" and illustrated in the attachment to this Ordinance, and contains 0.266 acres, more or less. The described real property shall exist within the boundaries of the City and be known to exist within said boundaries from the effective date of this Ordinance.

Section 2. City Boundaries Redefined. The boundary lines of the City of Springfield, Florida, are redefined to include said tract of land. The revision shall be filed with the Florida Department of State within 30 days of adoption. A certified copy of this Ordinance shall be submitted to the Office of Economic and Demographic Research along with a statement effect on population census and the affected land area.

Section 3. Repealer. All Ordinances or parts of Ordinances in conflict herewith are hereby repealed to the extent of such conflict.

Section 4. Severability. Should any section or provision of this Ordinance or any portion hereof, including any paragraph, sentence or word be declared by a court of competent jurisdiction to be invalid, such decision shall not affect the validity of the remainder hereto as a whole, and the invalid portion shall be severed from the remainder of this Ordinance and the remainder of this Ordinance shall continue to be lawful, enforceable and valid.

Section 5. This ordinance shall take effect immediately upon passage.

PASSED, APPROVED AND ADOPTED at the regular meeting of the City Commission of the City of Callaway, Florida, this 3<sup>rd</sup> day of July, 2017.

CITY OF SPRINGFIELD, FLORIDA

  
Ralph Hammond, Mayor

ATTEST:

  
Lee Penton, City Clerk

APPROVED AS TO FORM:

  
Kevin D. Obos, City Attorney

First Reading: June 5, 2017

Second Reading: July 3, 2017

PUBLISHED in the Panama City News-Herald on the 19<sup>th</sup> and 26<sup>th</sup> days of June,  
2017.

**ATTACHMENT TO ORDINANCE NO. 540**

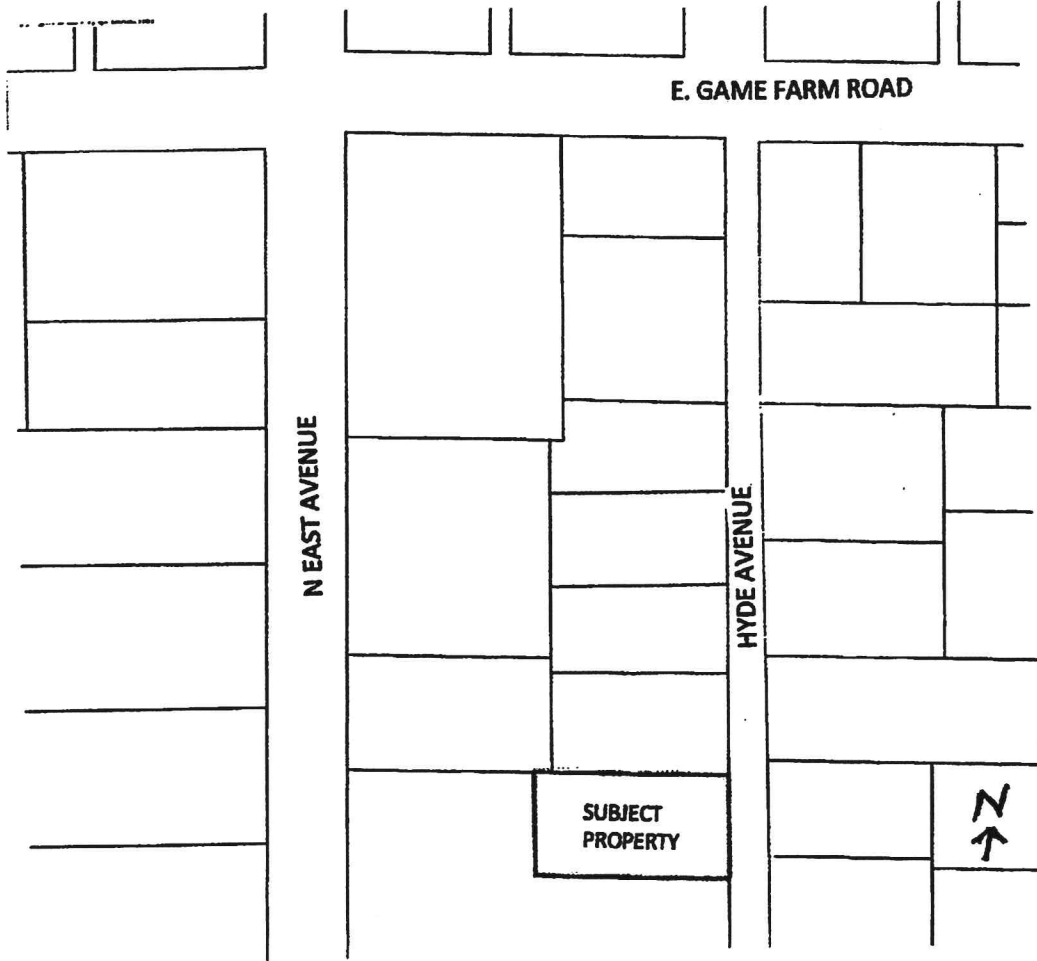

**EXHIBIT A**  
**TO ORDINANCE NO. 540**

**BEGINNING AT A POINT WHERE THE SOUTH LINE OF LOT 8, BLOCK 22, ST. ANDREWS BAY FARM AND FRUIT COMPANY PLANT OF HIGHLAND CITY INTERSECTS WITH THE EAST RIGHT-OF-WAY LINE OF EAST AVENUE; THENCE RUN EASTERLY ALONG THE SOUTH LINE OF SAID LOT 8 TO A POINT WHERE SAME INTERSECTS WITH THE WEST RIGHT-OF-WAY LINE OF SOUTH HYDE AVENUE; THENCE NORTH ALONG SAID WEST RIGHT-OF-WAY LINE OF HYDE AVENUE A DISTANCE OF 79 FEET TO THE POINT OF BEGINNING; THENCE CONTINUE ALONG SAID WEST RIGHT-OF-WAY LINE OF HYDE AVENUE A DISTANCE OF 80 FEET; THENCE WESTERLY 145 FEET; THENCE SOUTHERLY AND PARALLEL TO THE WEST RIGHT-OF-WAY LINE OF HYDE AVENUE A DISTANCE OF 80 FEET; THENCE EASTERLY TO THE POINT OF BEGINNING.**

**PROPERTY APPRAISER ID 12521-010-000**



HARRISON SALE  
McCLOY

Miramar Beach Santa Rosa Beach Panama City

304 Magnolia Ave  
Panama City, Florida 32401

850.769.3434

CORRESPONDENCE  
Postal Drawer 1579  
Panama City, Florida 32402

July 10, 2017

Lee Penton  
City Clerk  
City of Springfield  
3529 East 3rd Street  
Springfield, FL 32401

Re: David Head Annexation Ordinance No. 540

Dear Lee:

Enclosed are copies of letters to the State, the Governor's Office and the County sending each of them certified copies of the David Head annexation ordinance. Also enclosed is the original recorded document.

If you need anything further, please let me know.

Very truly yours,

A handwritten signature in cursive script that reads 'Susan'.

Susan J. Moore  
Municipal Paralegal

Enclosures as stated



HARRISON SALE  
McCLOY  
Panama City | Santa Rosa Beach | Destin

304 Magnolia Ave  
Panama City, Florida 32401  
850.769.3434

CORRESPONDENCE  
Postal Drawer 1579  
Panama City, Florida 32402

July 10, 2017

Board of Bay County Commissioners  
840 West 11<sup>th</sup> Street  
Panama City FL 32401

Re: Voluntary Annexation  
City of Springfield FL

Gentlemen:

Enclosed please find certified copy of below-described annexation ordinance for the City of Springfield. This ordinance is being filed with your office in compliance with Chapter 171.044(3), Florida Statutes:

Ordinance #540 City of Springfield, Parcel ID 12521-010-000, Hyde Avenue (no street number) (see map attached to the ordinance).

We would appreciate your forwarding an acknowledgment that the above-referenced ordinance has been filed with your office. Should you have any problems or questions, please do not hesitate to call. Thank you for your courtesies.

Very truly yours,

A handwritten signature in cursive script that reads "Susan Moore".

Susan J. Moore  
Municipal Paralegal

Enclosure: As Noted

cc: Lee Penton, City Clerk





HARRISON SALE  
McCLOY

Miramar Beach Santa Rosa Beach Panama City

304 Magnolia Ave  
Panama City, Florida 32401

850.769.3434

CORRESPONDENCE  
Postal Drawer 1579  
Panama City, Florida 32402

July 10, 2017

Ernest L. Reddick  
Program Administrator  
Department of State  
R.A. Gray Building  
500 South Bronough Street  
Tallahassee, FL 32399-0250

RE: City of Springfield

Dear Mr. Reddick:

Enclosed please find certified copy of below-described annexation ordinance for the City of Springfield. This ordinance is being filed with your office in compliance with Chapter 171.044(3), Florida Statutes:

Ordinance #540 City of Springfield, Property ID 12521-010-000, Hyde Avenue (no street number) (see map attached to the ordinance).

We would appreciate your forwarding an acknowledgment that the above-referenced ordinance has been filed with your office. Should you have any problems or questions, please do not hesitate to call. Thank you for your courtesies.

Yours very truly,

A handwritten signature in cursive script that reads "Susan Moore".

Susan J. Moore  
Municipal Paralegal

Enclosure: Certified Copy of Ordinance No. 540

cc: Lee Penton, City Clerk



**HARRISON SALE  
McCLOY**

Miramar Beach Santa Rosa Beach Panama City

304 Magnolia Ave  
Panama City, Florida 32401

850.769.3434

CORRESPONDENCE  
Postal Drawer 1579  
Panama City, Florida 32402

July 10, 2017

Ernest L. Reddick  
Program Administrator  
Department of State  
R.A. Gray Building  
500 South Bronough Street  
Tallahassee, FL 32399-0250

RE: City of Springfield

Dear Mr. Reddick:

Enclosed please find certified copy of below-described annexation ordinance for the City of Springfield. This ordinance is being filed with your office in compliance with Chapter 171.044(3), Florida Statutes:

Ordinance #540      City of Springfield, Property ID 12521-010-000, Hyde Avenue (no street number) (see map attached to the ordinance).

We would appreciate your forwarding an acknowledgment that the above-referenced ordinance has been filed with your office. Should you have any problems or questions, please do not hesitate to call. Thank you for your courtesies.

Yours very truly,

Susan J. Moore  
Municipal Paralegal

Enclosure: Certified Copy of Ordinance No. 540

cc: Lee Penton, City Clerk



HARRISON SALE  
McCLOY

Miramar Beach Santa Rosa Beach Panama City

304 Magnolia Ave  
Panama City, Florida 32401

850.769.3434

CORRESPONDENCE  
Postal Drawer 1579  
Panama City, Florida 32402

July 10, 2017

Lee Penton  
City Clerk  
City of Springfield  
3529 East 3rd Street  
Springfield, FL 32401

Re: David Head Annexation Ordinance No. 540

Dear Lee:

Enclosed are copies of letters to the State, the Governor's Office and the County sending each of them certified copies of the David Head annexation ordinance. Also enclosed is the original recorded document.

If you need anything further, please let me know.

Very truly yours,

Susan J. Moore  
Municipal Paralegal

Enclosures as stated



**HARRISON SALE  
McCLOY**  
Panama City | Santa Rosa Beach | Destin

304 Magnolia Ave  
Panama City, Florida 32401  
850.769.3434

CORRESPONDENCE  
Postal Drawer 1579  
Panama City, Florida 32402

July 10, 2017

Board of Bay County Commissioners  
840 West 11<sup>th</sup> Street  
Panama City FL 32401

Re: Voluntary Annexation  
City of Springfield FL

Gentlemen:

Enclosed please find certified copy of below-described annexation ordinance for the City of Springfield. This ordinance is being filed with your office in compliance with Chapter 171.044(3), Florida Statutes:

Ordinance #540      City of Springfield, Parcel ID 12521-010-000, Hyde Avenue (no street number) (see map attached to the ordinance).

We would appreciate your forwarding an acknowledgment that the above-referenced ordinance has been filed with your office. Should you have any problems or questions, please do not hesitate to call. Thank you for your courtesies.

Very truly yours,

A handwritten signature in cursive script that reads "Susan Moore".

Susan J. Moore  
Municipal Paralegal

Enclosure: As Noted

cc: Lee Penton, City Clerk



**HARRISON SALE  
McCLOY**

Miramar Beach Santa Rosa Beach Panama City

304 Magnolia Ave  
Panama City, Florida 32401

850.769.3434

CORRESPONDENCE  
Postal Drawer 1579  
Panama City, Florida 32402

July 10, 2017

Clyde L. Diao, PhD  
Deputy Policy Coordinator  
Governor's Liaison for Census 2020  
Office of Policy and Budget  
Room 1604, The Capitol  
400 South Monroe Street  
Tallahassee FL 32399-001

RE: City of Springfield

Dear Dr. Diao:

Enclosed please find certified copy of below-described annexation ordinance for the City of Springfield, adopted by the City July 3, 2017. This ordinance is being filed with your office in compliance with Chapter 171.044(3), Florida Statutes:

Ordinance #540      City of Springfield, Parcel ID 12521-010-000, approximately  
0.266 acres, Hyde Avenue (no street number assigned) (see map  
attached to the ordinance).

We would appreciate your forwarding an acknowledgment that the above-referenced ordinance has been filed with your office. Should you have any problems or questions, please do not hesitate to call.

Yours very truly,

A handwritten signature in cursive script that reads "Susan Moore".

Susan J. Moore  
Municipal Paralegal

Enclosure: Certified Copy of Ordinance No. 540

cc: Lee Penton, City Clerk